



N 207 ECP

- Popular item
- SKF Explorer

Cylindrical roller bearings, single row

Bearing data

[Tolerances](#),
Normal (metric), P6, Normal (inch),
[Radial internal clearance](#),
cylindrical bore, tapered bore,
[Axial internal clearance](#),
NUP, NJ + HJ

Bearing interfaces

[Seat tolerances for standard conditions](#),
[Tolerances and resultant fit](#)

Technical specification

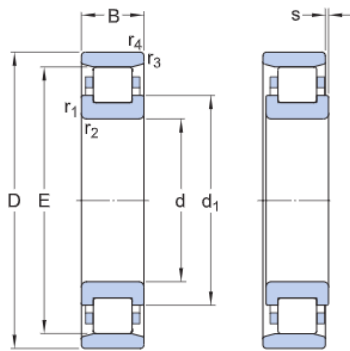

DIMENSIONS

d	35 mm	Bore diameter
D	72 mm	Outside diameter
B	17 mm	Width
d1	≈48.1 mm	Shoulder diameter of inner ring
E	64 mm	Raceway diameter of outer ring
r1,2	min.1.1 mm	Chamfer dimension
r3,4	min.0.6 mm	Chamfer dimension
s	max.1.3 mm	Permissible axial displacement

ABUTMENT DIMENSIONS

da	min.41.8 mm	Diameter of spacer sleeve
da	max.62 mm	Diameter of spacer sleeve
Da	min.66 mm	Diameter of housing abutment
Da	max.67.2 mm	Diameter of housing abutment
	max.1	Radius of

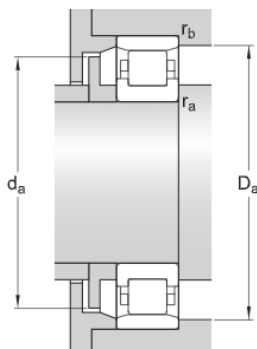

ra	mm	fillet
rb	max.0.6 mm	Radius of fillet

CALCULATION DATA

Basic dynamic load rating	C	56 kN
Basic static load rating	C ₀	48 kN
Fatigue load limit	P _u	6.1 kN
Reference speed		11 000 r/min
Limiting speed		12 000 r/min
Minimum load factor	k _r	0.12
Limiting value	e	0.2
Axial load factor	Y	0.6

MASS

Mass		0.3 kg
------	--	--------